

LOW PROFILE BARRIER

1.2m Transition

Product No: SP35411

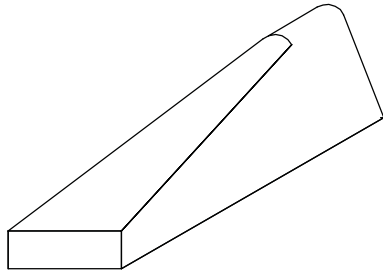

TECHNICAL DATA	
CSA Approved Conforms with CSA Standard A23.4-00	
Concrete	35 MPa @ 28 days Cement: Type 30
Steel	Grade 400
Mass	240 kg (530 lbs.)

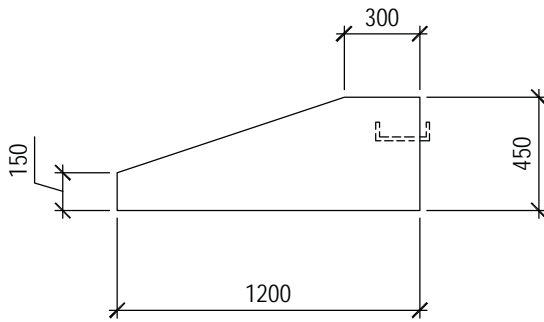

SIDE ELEVATION

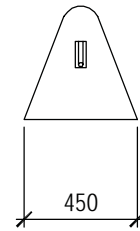

FEMALE END ELEVATION

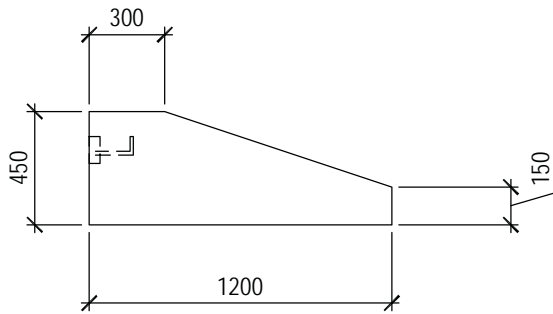

SIDE ELEVATION

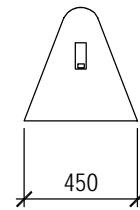

MALE END ELEVATION